



Price	€185 M
Name	-
Builder	Bremer Vulkan
Origin	-
Year/Refit	New Construction
Overall Length	105.00 m / 344' 00"
Length at Waterline	-
Beam	20.00 m / 65' 06"
Draught max.	5.50 m / 18' 00"
Gross tonnage	6400 grt
Displacement	-
Engines	2 x MTU
Speed (Max / Crusie)	- / -
Range	-
Accommodation	36 guests in 18 staterooms, 20 crew in 10 cabins
Type	Motor Yacht
Class	Lloyds
Flag	-
Hull Type	Mono Hull
Hull Material	Steel
Superstructure Material	Aluminum
Hull Configuration	Displacement
Number of Decks	5
Naval Architecture	Claus Kusch of Kusch Yacht Agentur
Exterior Design	Claus Kusch of Kusch Yacht Agentur
Interior Design	Pauline Nunns (Heinz Vollers/Katalin Landon)















GENERAL ARRANGEMENT

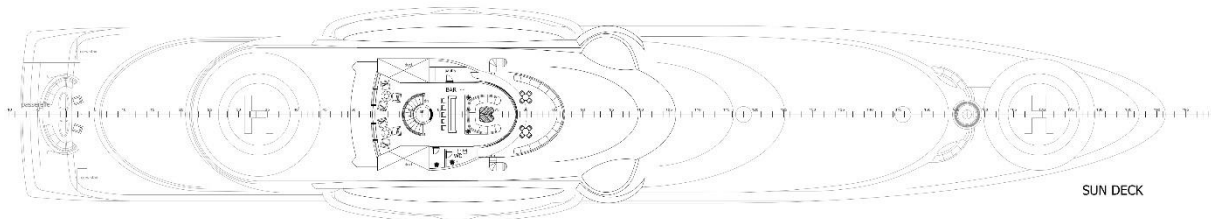
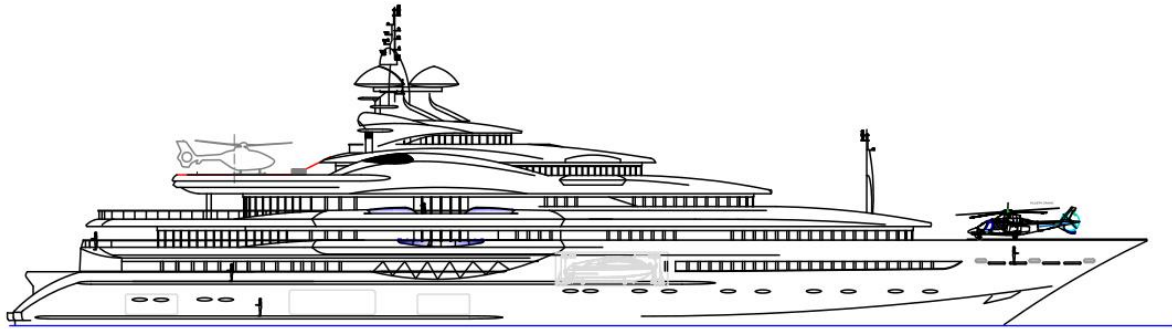

SUN DECK

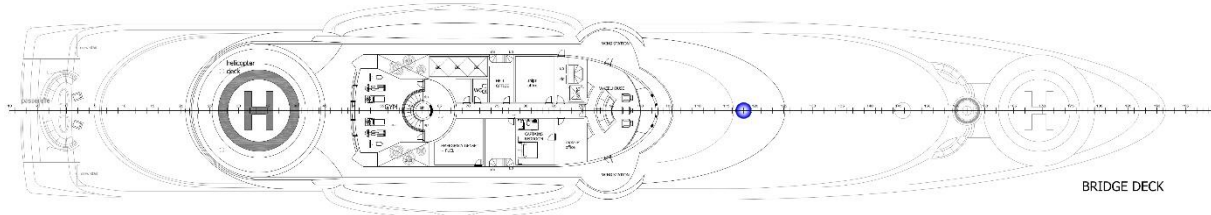

BRIDGE DECK

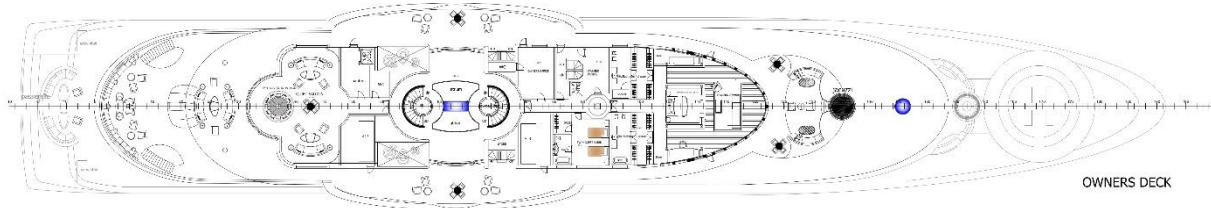

OWNERS DECK

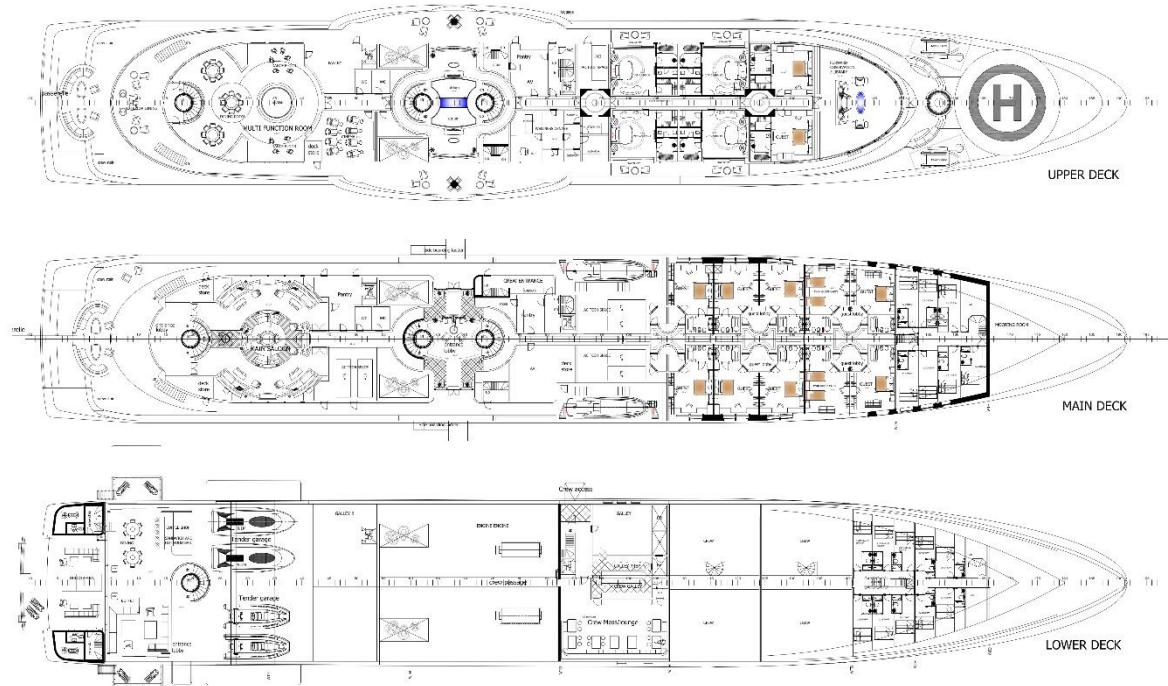



SUMMARY

She is intended to be a Pleasure Yacht, offering adventure and stress-free enjoyment to the lucky few. The cruising area is envisioned to be worldwide regions, the ship should be very self-sufficient to operate in remote areas without port facilities. Systems need to be as simple and reliable as possible with good redundancy. She is constructing in Bremer Vulkan AG shipyard.

SPECIAL FEATURES

Several large shell doors P+S cut into the ship's hull. 2 x Tender Garage doors, top hinged to permit launch & recovery of tenders 1 x Balcony doors in the Health Spa, bottom hinged shell doors that open to create a balcony 2 x Low level shell doors for tender embarkation Bow shape, curved stem, noticeable chine which in addition to more innovative appearance has some advantages – longer waterline length, lower resistance, lower power requirement, lower acceleration in rough sea, which allows increased comfort & speed in a seaway and the chine reduced spray.

TENDERS & WATER TOYS

A large tender garage. The tender garage close to the water, it is low enough to allow quick launch & recovery. Overhead beam cranes are provided for that purpose. The cranes are multi-purpose.

LIFERAFTS

There are 2 rescue/lifeboats. Providing rescue capacity on either ship side. Life raft capacity for 100% of persons onboard, suitable for extended voyages.

18 GUEST ACCOMMODATION INCLUDING

- 1 x Owner with balcony (Yacht Standard)
- 4 VIP with Balcony (Yacht Standard)
- 10 Doubles (High end commercial)
- 3 Twins (High end commercial)

GUEST PUBLIC SPACES

- Dining room
- Main lounge Bar Dining
- Fwd observation lounge/Library
- Aft Quiet Saloon
- Cinema
- Sun deck bar
- Spa Wellness (Hamman, massage room. Sauna)



- Fitness Centre

OPERATIONAL SPACES

- Galley - Pantries
- Refrigerates Stores
- Dry Stores
- Boat Garage
- Bridge
- Covered mooring deck
- Laundry
- Crew Gymnasium
- Crew Entertainment area

CREW SPACES

- 10 single cabins
- 16 double cabins
- 4 single occupancy for Entourage / Security

MACHINERY

Simple and reliable systems to be selected to assure the ships ability to operate away from developed ports and infrastructure. The self-sufficiency is intended to include and permit the ability to bypass systems and automation and run as many systems as practical in a get home mode, allowing the ship to be able to maintain basic safe operation, and propulsion power even in the event of damage, to allow the ship to continue its voyage out of remote areas without assistance, towards ports where shore support is more practical.

ELECTRICAL GENERATION

4 Diesel Generators are fitted with particle filters and high spec silencers. Emergency Generator High Speed Diesel generator, 380V 50Hz 3ph.

OTHER EQUIPMENT

- Hot water heater, with electrical heating elements
- Reverse osmosis fresh water makers 2 x 30 tons/day
- Vacuum Toilet system, with built in redundancy
- Biological Sewage treatment plan
- Sophisticated waste treatment plant

INTEGRATED NAVIGATION BRIDGE

- 2 x ARPA radar, 1 planning screen, interface with ships computer network
- GMDSS Radios station sea areas A1,A2 & A3



- Machinery & systems monitoring screen
- Safety system, Fire doors monitoring, Watertight door monitoring, Fire detection & monitoring
- PA & alarm system, ISPS security systems

HULL & SUPERSTRUCTURE

The Hull form is developed in the Naval Architecture section and the Superstructure will be shown in the Arrangement Plans and Perspective View. For the construction of the Hull and Superstructure, the Basic Design Drawings will be developed showing method of construction and principal material types and thickness (scantling drawings). The remaining structure including; box, stern, appendages, engine foundations etc will not be developed in the detail at this stage.

- Mid ship Section and 6 typical sections
- Decks & double bottom & helideck
- Longitudinal section & scantling calculation
- Shell expansion & scantling calculation
- Structural weight calculation

KEY FEATURES

- Commercial platform with super yacht finish
- 6400 grt
- 18 cabins for 36 guests
- Lloyd register, SOLAS, MCA UK
- H2 design
- Will be built in Germany
- 2 heli decks
- Diesel electric propulsion
- "U" shaped clear glass structure
- Helipad located forward
- 'Glass house' on the fly deck with a breath taking 180° panoramic view and a wide opening on the deck

All speeds, measurements, capacities, consumptions, etc., may be approximate or estimated. Specifications provided for information only. Data was obtained from sources believed to be reliable and is not guaranteed by Owner or Brokers. Buyer assumes the responsibility to ascertain the correctness of all data contained herein and otherwise provided and must instruct his agent and surveyors to confirm all details for accuracy prior to purchase. Subject to prior sale, price and inventory change, or withdrawal from market without notice.