



Price	€2.30 M (EU VAT paid)
Name	Enigma
Builder	Benetti
Origin	Italy
Year/Refit	2004 / -
Overall Length	30.20 m / 99' 10"
Length at Waterline	25.5 m / 83' 80"
Beam	7.19 m / 23' 70"
Draught (Max.)	1.79 m / 5' 10"
Gross Tonnage	193 grt
Displacement	152 tonnes
Engines	2 x 1350 hp MTU 12V 2000M90
Speed (Max / Cruise)	18 knots / 16.5 knots
Range	-
Fuel Capacity	25000 lts
Accommodation	8 guests in 4 staterooms, 5 crew in 2 cabins
Type	Motor Yacht
Class	Lloyds Register
Flag	Malta
Hull Type	Mono hull
Hull Material	GRP
Superstructure Material	GRP
Hull Configuration	Semi-displacement
Number of Decks	2.5
Naval Architecture	Benetti
Exterior Design	Stefano Righini
Interior Design	François Zuretti

























GENERAL ARRANGEMENT

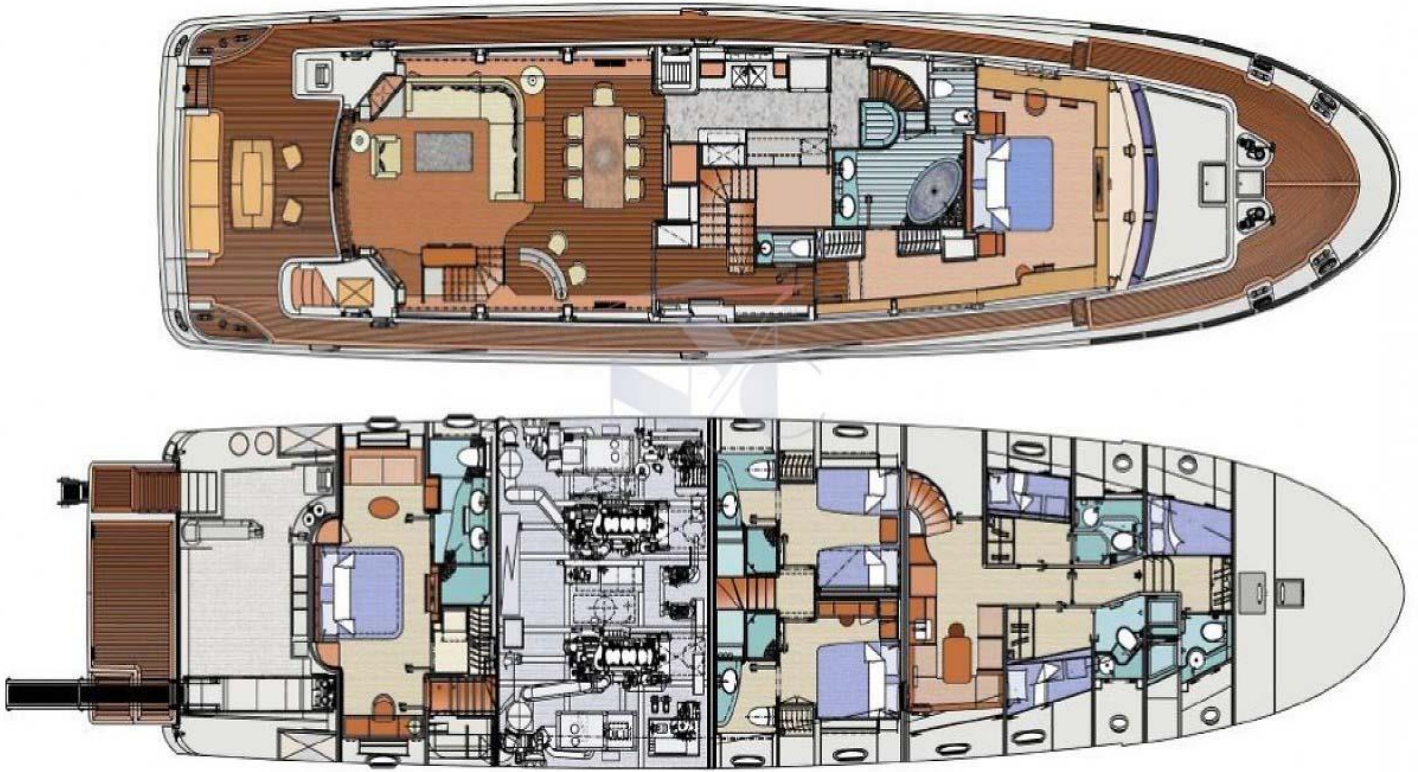



SUMMARY

The 30.24 m/98'5" motor yacht ENIGMA (ex. Vila Velebita Tri) was built by Benetti in Italy at their Fano shipyard. Her interior is styled by French designer design house Zuretti and she was completed in 2004. Her exterior design is the work of Stefano Righini.

ENIGMA has been designed to comfortably accommodate up to 8 guests in 4 suites comprising one VIP staterooms. She is also capable of carrying up to 5 crew onboard to ensure a relaxed luxury yacht experience.

She is amazing yacht, with a lot of potential comfort and performance. Elegantly designed lines express power and dynamism. The driving experience is fluid and intuitive. There is a separating between the cockpit and the saloon with an electrically opening mirror glass.

Built with a GRP hull and superstructure, with teak decks, she benefits from a semi-displacement hull to provide exceptional seakeeping and impressive speeds. Powered by 2 MTU (12V 2000M90) 1,350hp engines, she comfortably cruises at 14 knots, reaches a maximum speed of 17 knots with a range of up to 2,100 nautical miles from her 22,000 liters fuel tanks at 10 knots. Her water tanks store around 5,500 liters of fresh water. She was built to Lloyds Register classification society rules.

KEY FEATURES

- Electrically opening mirror glass which separates cockpit and saloon
- The third deck area provides a wide sunbathing area
- The spacious cockpit offers comfortable seats and dining table for 10 guests
- Generous stern platform at aft
- Provides corner bar, circular shaped sofa, round table for 8 guests on upper deck
- 2010 model Walker Bay tender with 4 stroke Honda outboard engine

All speeds, measurements, capacities, consumptions, etc., may be approximate or estimated. Specifications provided for information only. Data was obtained from sources believed to be reliable and is not guaranteed by Owner or Brokers. Buyer assumes the responsibility to ascertain the correctness of all data contained herein and otherwise provided and must instruct his agent and surveyors to confirm all details for accuracy prior to purchase. Subject to prior sale, price and inventory change, or withdrawal from market without notice.